

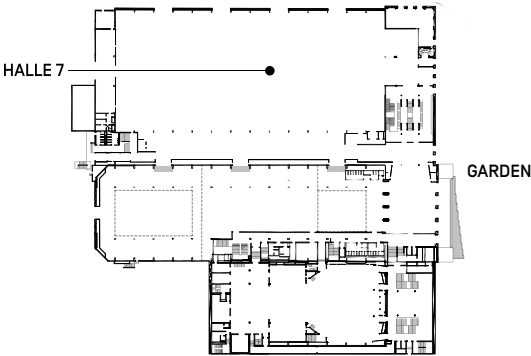

Hall 6-7 is a versatile, multi-purpose space with direct access from the central hall, as well as a private outside entrance. The ceiling structure offers a wide range of possibilities for hanging and partitioning the area, allowing for flexible use of the space. A comprehensive network of channels facilitates the installation of electrical, water, and IT systems to suit a variety of needs. The hall regularly hosts general meetings, exhibitions, sport events, and corporate parties. Ideally situated at the heart of the main building, Hall 6-7 is easily interconnected with Hall 1 as well as the Sydney and Seoul conference rooms, allowing conferences and exhibitions to be combined on one floor. On the second floor, the Turin and London conference rooms offer uninterrupted views of the hall and are frequently used as technical control rooms or steering offices for events hosted in Hall 6-7.

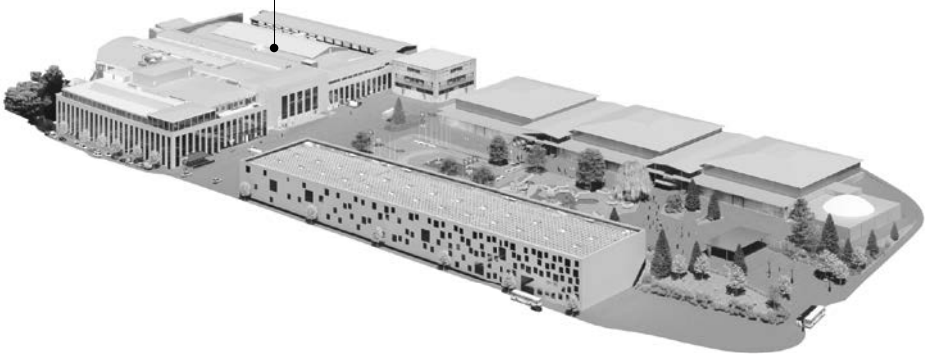

Convention Centre
Level 1



FEATURES

Level	1
Total usable area	5000 m ²
Height	7 m - 11 m
Floor covering	Concrete
Floor load	1000 kg/m ²
Lift access	Yes
PRM access	Yes



Exams
670 seats



Training
1620 seats



Theatre
4090 seats



Banquet
1800 seats



Cocktail reception
4400 seats

INFRASTRUCTURE & EQUIPMENT

INFRASTRUCTURE

- Direct access from underground car park and central hall
- Logistics access from the rear of the Hall [dedicated loading bay]
- 168 attachment points, each with a 500 kg/p capacity
- 84 attachment points, each with a 1000 kg/p capacity
- Channels for electrical, IT, and water networks [further details available upon request]
- Heating and ventilation system
- High-speed Wi-Fi
- 2 toilet blocks [women, men] on the same floor