

The Turin Room consists of four modules of varying sizes [AB, ABC, ABCD] which can be used individually or combined—ideal for hosting conferences, workshops or even exams. The modules can be tailored to meet your specific technical and layout requirements. Each room is equipped with fixed, interconnectable projection systems, enabling a seamless transition from one large space to four individual modules on the same day. This space is also the perfect breakout room for conferences or corporate events.

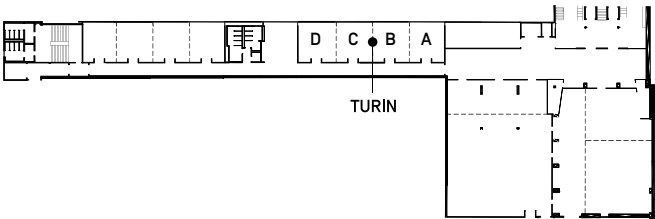

FEATURES	
Level	2
Total usable area	40 m² [A] 170 m² [ABCD]
Height	3.9 m
Floor covering	Parquet
Floor load	300 kg/m²
Lift access	Yes
PRM access	Yes

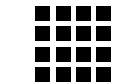
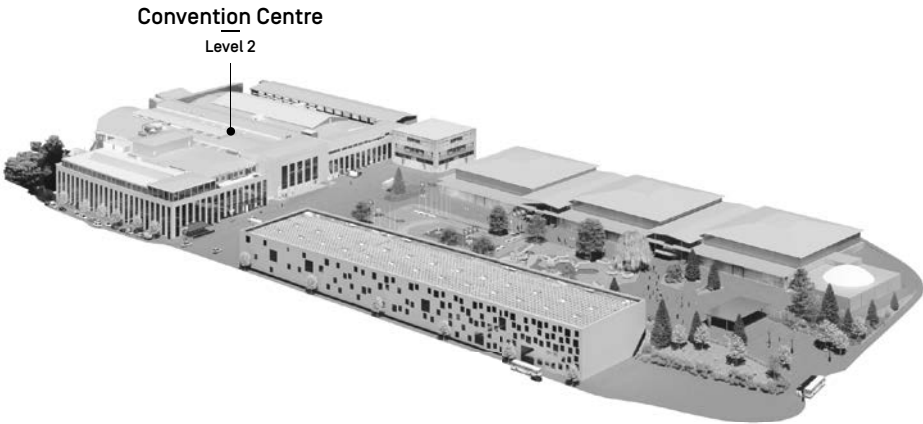

Training
18 seats [A]
90 seats [ABCD]



Theatre
50 seats [A]
180 seats [ABCD]



Exams
30 seats [ABCD]



Cocktail reception
150 seats [ABCD]

INFRASTRUCTURE & EQUIPMENT

INFRASTRUCTURE

- Direct access from the underground car park and central hall
- Dynamic signage with welcome screen
- Adjacent area for coffee breaks, meals, cocktail receptions and exhibitions
- Heating and ventilation system
- High-speed Wi-Fi
- 3 toilet blocks [women, men, PRM] on the same floor

GOODS LIFT

- Dimensions : 3.80×2.35×2.45
- Load : 5000 kg

TECHNICAL SPECIFICATIONS

PROJECTION

PROJECTION SYSTEM FOR SINGLE MODULES

TURIN A & TURIN D MODULES

- Single-wall projection
- 1× 4400 lumen video projector: Panasonic PT-VZ470, 1920×1200 resolution
- HDMI connection

TURIN B & TURIN C MODULES

- 2× Panasonic Full HD 55" LCD TH-55LFE8 screens
- HDMI connection

PROJECTION SYSTEM FOR COMBINED MODULES

- Single-wall projection
- 1× 4400 lumen video projector: Panasonic PT-VZ470, 1920×1200 resolution
- HDMI connection
- 2× Panasonic Full HD 55" LCD TH-55LFE8 repeater screens for double modules, or 4× Panasonic Full HD 55" LCD TH-55LFE8 repeater screens for quadruple modules

SOUND

MIXING

- YAMAHA MG12 console; 6 mic/line inputs; 4 outputs

AUDIO DISTRIBUTION

- 4× SoundTube RS600i two-way 6" ceiling speakers in each module
- 2× Shure MX418 lectern microphones
- Additional handheld and headset microphones available on request

LIGHTING

- Room lighting is adjustable via a dimmer switch. DMX controllers not available.